

# MIXED USE

Sale: \$3,000,000

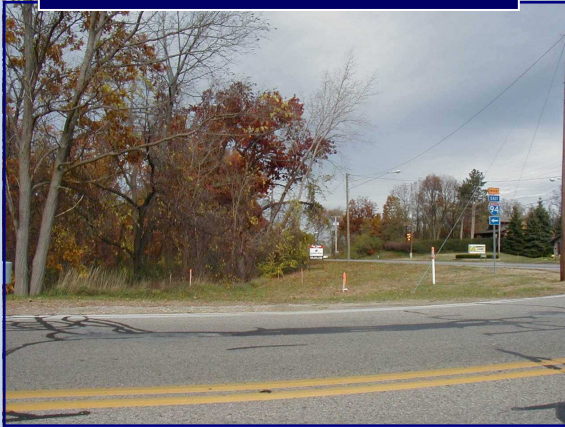

- Total Size: 56.28 Acres
- Residential: 10.5 Acres (East of I-94)
- Commercial: 45.78 Acres (West of I-94)
- Average Daily Traffic: 40,000 Cars
- May Sub-Divide

## Red Arrow Highway Land

Red Arrow Highway at Exit 22  
Stevensville, MI 49127  
(Lincoln Charter Township)

**56.28 acres** located on both sides of I-94 just east of Exit 22 (Red Arrow Highway). MDOT average daily traffic count is over 40,000 cars. Excellent hotel, retail, office or restaurant sites on west side of I-94 and residential development opportunity available on east side of I-94. Owner is willing to sub-divide.

### Site Contact Information:

Grubb & Ellis / Cressy & Everett  
2241 U.S. 12 East  
Edwardsburg, MI 49112  
Phone: (269) 699-5502

Jim Ringler  
Email: [JimRingler@CressyAndEverett.com](mailto:JimRingler@CressyAndEverett.com)  
Noah Davey  
Email: [NoahDavey@CressyAndEverett.com](mailto:NoahDavey@CressyAndEverett.com)



Berrien County Community Development  
Jennifer Arent  
701 Main Street  
St. Joseph, MI 49085

Phone: (269) 983-7111 x8788  
Fax: (269) 982-8611  
E-mail: [jarent@berriencounty.org](mailto:jarent@berriencounty.org)  
Website: [www.berriencounty.org](http://www.berriencounty.org)